

# Hotel 1000, Seattle

Situated in the heart of Downtown Seattle, Hotel 1000 reflects the lush surroundings and urban elegance of the Emerald City.

1000 First Ave  
Seattle, WA 98104  
206.957.1000

## Getting Here

Seattle Tacoma International Airport:  
14 miles

## Rooms and Suites

120 newly redesigned luxury guestrooms, including 36 suites with peaceful water or vibrant city views and a 2000 square foot presidential grand suite.

## Meetings and Events

Downtown Seattle is the perfect backdrop for your next meeting. Featuring eight flexible function spaces with energizing natural light, modern refinement and leading-edge technology that can accommodate any size group, from an intimate gathering of 12 to celebratory party of 200.

## Dining and Entertainment

### All Water Seafood & Oyster Bar

This popular downtown restaurant offers boat-to-table cuisine, hand-crafted cocktails and fresh artisan ingredients directly from local farmers and Pike Place Market. The private dining room welcomes up to 35 guests for business dinners or special celebrations.

### Bell Lounge

Relax fireside in a cozy velvet booth with a seasonal collection of artisan cocktails.

### Flavor Hotel 1000 :

Eating Like a Local Made Easy. We've brought the local food scene to you by partnering with some of our favorite neighborhood food and drink artisans. Serving it up fresh, right here in the hotel.

## Things to Do

- The Spa at Hotel 1000 is an oasis of indulgence with rejuvenating treatments, a relaxation lounge and sauna.
- Hit the links at Seattle's only virtual-reality golf club, offering 52 world-renowned courses.
- 24-hour fitness center with state-of-the-art exercise equipment.
- A short walk from the waterfront along Elliott Bay, Pike Place Market, Seattle Art Museum, CenturyLink Field, and historic Pioneer Square.

## At Your Service

- Complimentary Wi-Fi in public spaces and every guestroom
- Dry cleaning, pressing and shoe shine
- Safe deposit boxes
- 24-hour in-room dining
- Onsite PSAV Audio/Visual
- 24-hour business center
- Valet parking available
- Chat Your Service: need a restaurant reservation or the AC turned up? Just text us and we've got you covered

## Level Four

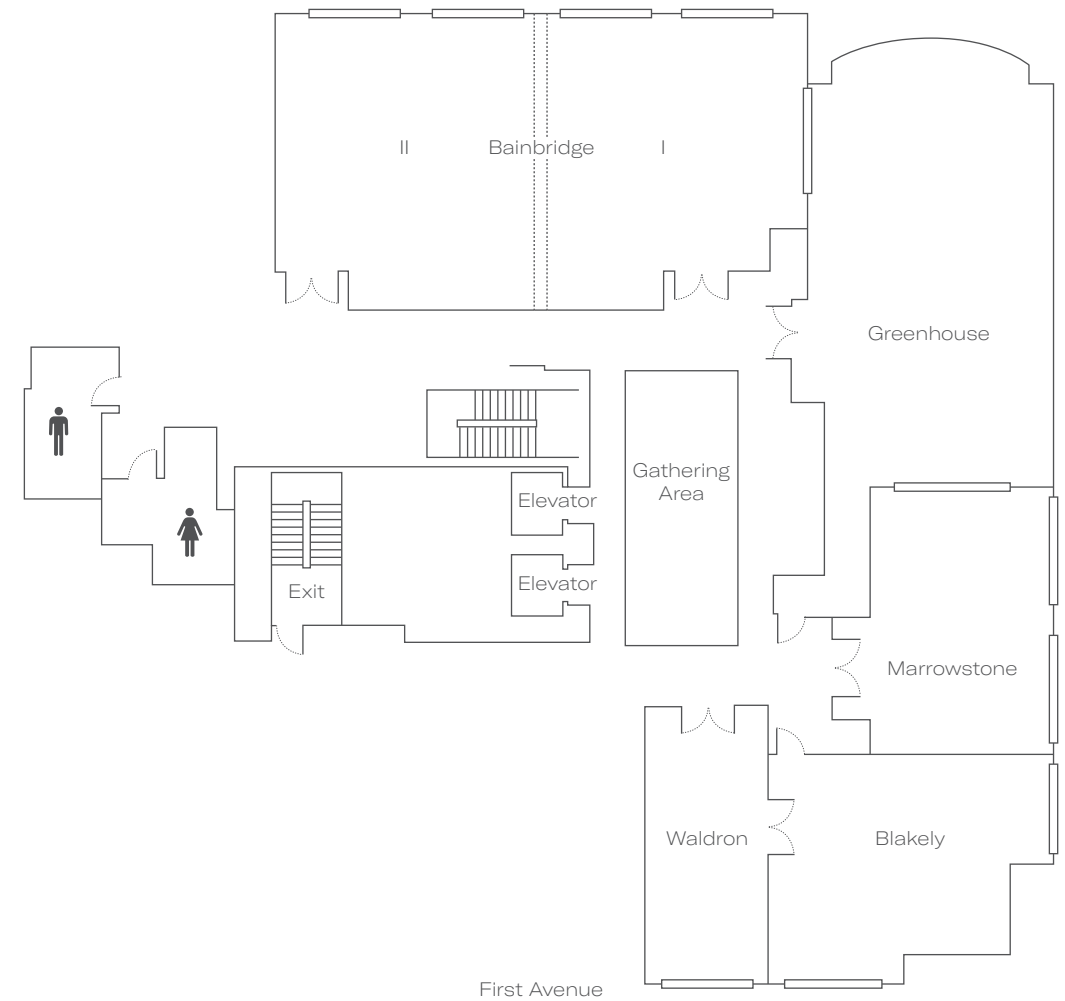

Room	Sq. Ft.	Dimensions	Crescent	Square	Rounds	Reception	Classroom	Theatre	Conference	U-Shape	Ceiling
<b>Level Four</b>											
Bainbridge	1856	58 x 27	72	46	120	200	80	180	40	46	9
Bainbridge I	932	30 x 27	30	30	50	80	40	80	18	30	9
Bainbridge II	836	27 x 27	30	30	50	80	40	80	18	30	9
Greenhouse	1160	40 x 29	48	40	80	110	80	120	32	38	9
Marrowstone	567	24 x 21	6		20	20			16		9
Blakely	693	31 x 22	24	60	40	40	25	40	20	22	9
Waldron	377	29 x 13							12		9
Gathering Area	966	42 x 23				90					9

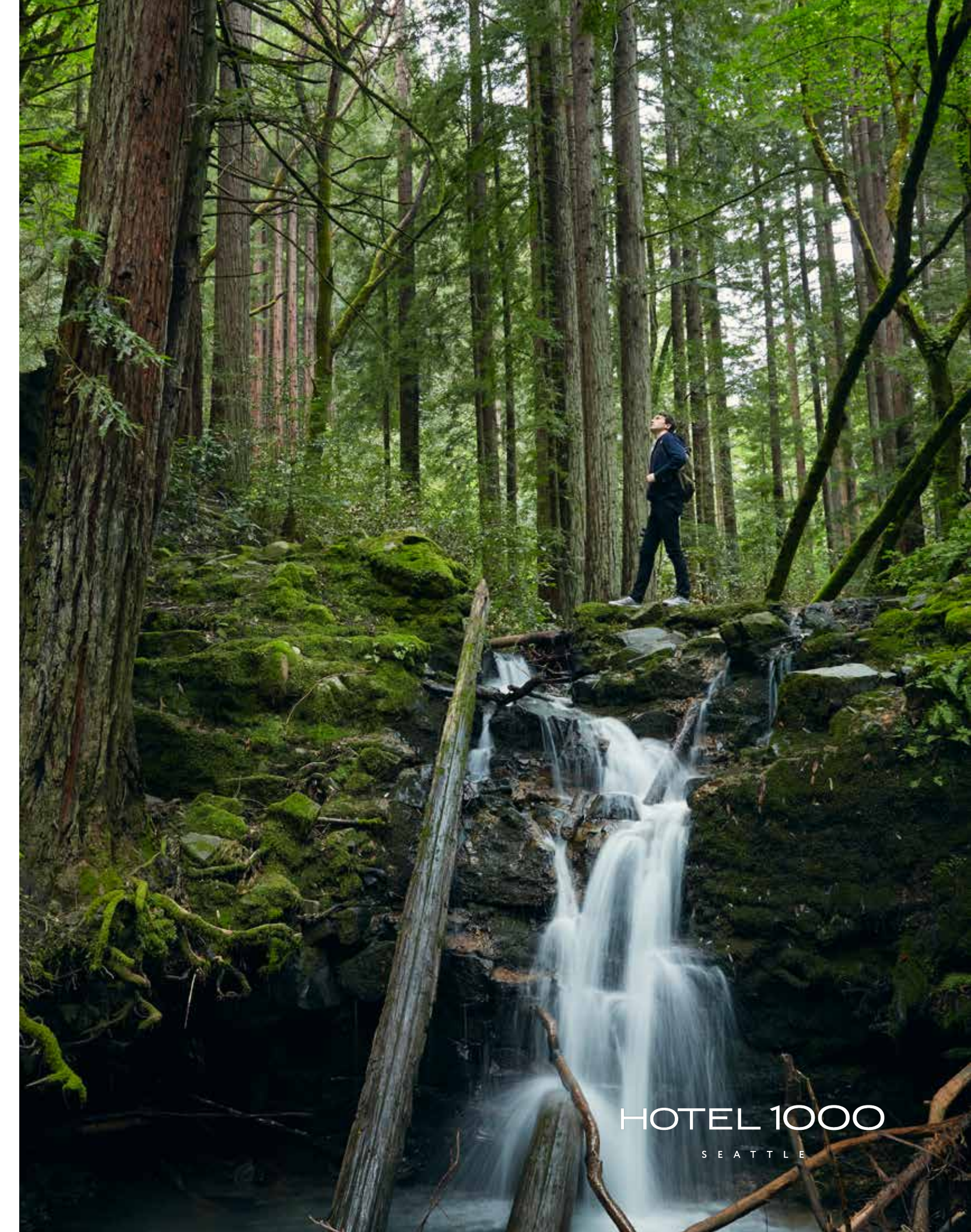

**HOTEL 1000**  
SEATTLE

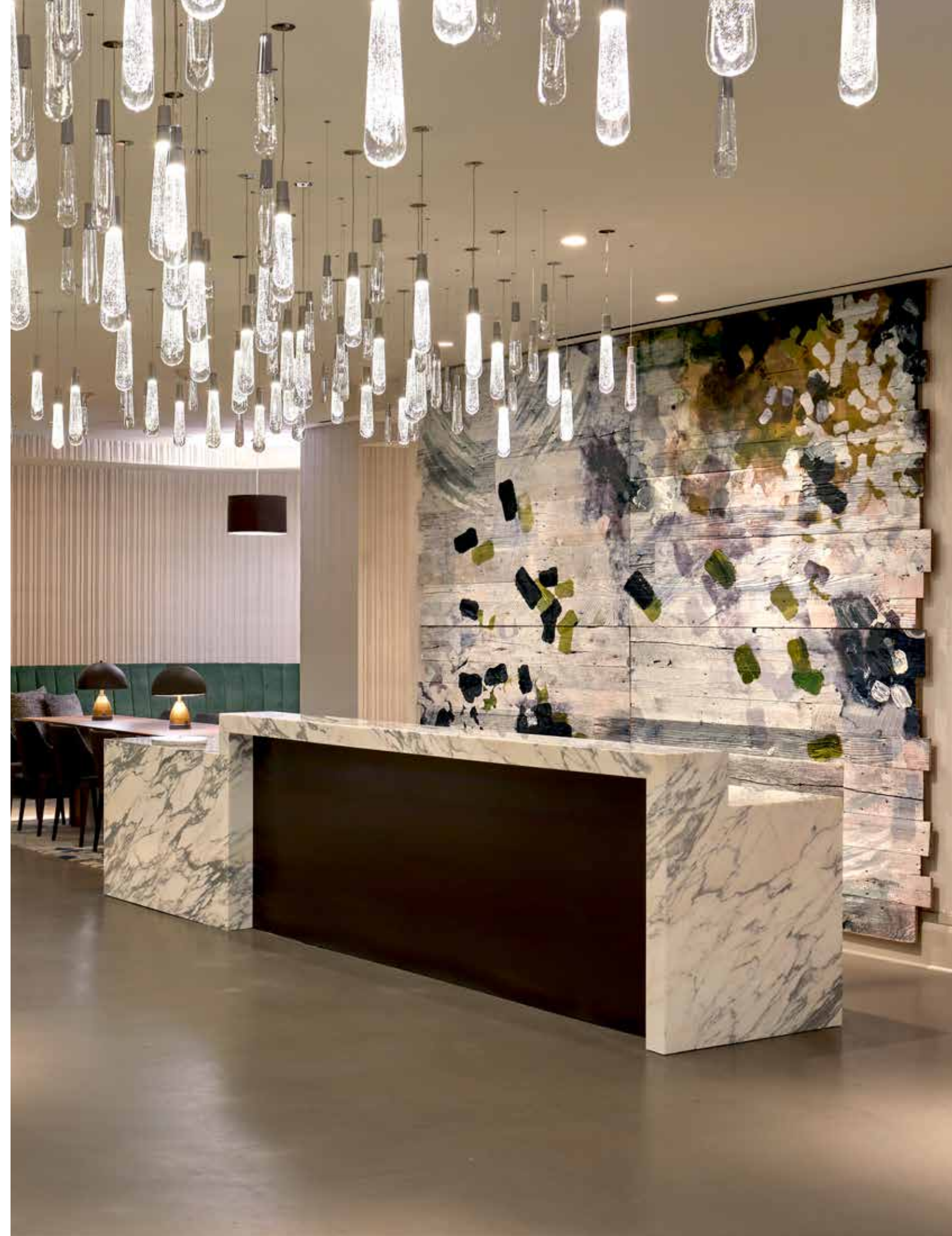

## Level Two

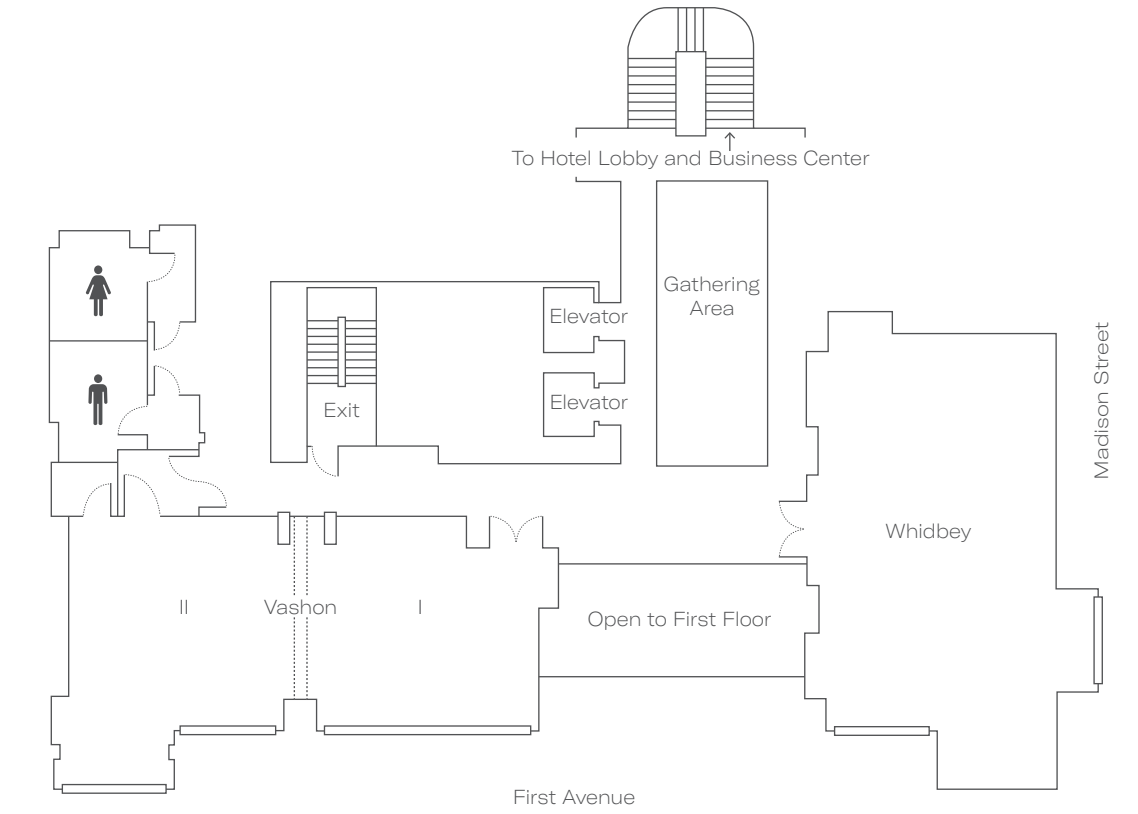

Room	Sq. Ft.	Dimensions	Crescent	Square	Rounds	Reception	Classroom	Theatre	Conference	U-Shape	Ceiling
<b>Level One</b>											
Bell Lounge (not shown)	930	30 x 30			30	30			20	15	9
<b>Level Two</b>											
Whidbey	1299	44 x 26	48	40	80	90	60	100	32	32	9
Vashon	1338	52 x 24	42	42	80	90	60	100	32	32	9
Vashon I	624	26 x 24	24	18	30	40	25	40	16	18	9
Vashon II	715	26 x 24	24	18	30	40	25	40	16	18	9
Gathering Area	950	44 x 20				60					9

Clockwise from top: Bainbridge ballroom, Waldron boardroom, deluxe water view king guestroom